

Thank you for purchasing this Rokuhan product. This is a precision train model, so please handle carefully. Please read this instruction manual carefully before you operate.

1. Caution

- Use only a Rokuhan controller to operate this product.
- Clean track surface (Metal rails) before operation.
- Remove dirt and dust on wheels.
- Do NOT operate continuously over a long period of time.
- Do NOT suddenly change train direction. Stop train first then change direction.
- In the case of derailment or short circuit, power off controller switch, unplug the AC adapter, and then eliminate the cause of problem.
- Disassembling and modification could cause failure of this product.
- Storing this product in direct sunlight or fluorescent light for a long time could cause change in color.
- Store and operate this product in dust free locations, away from sources of heat and moisture.
- To avoid shock or electrocution, do not operate this product in a wet location or operate with wet hands.
- This product includes sharp edge parts. Handle with care.
- Handle tools with care.
- This product is NOT recommended for use by children under 15 years old unless supervised by an adult.

2. Parts List

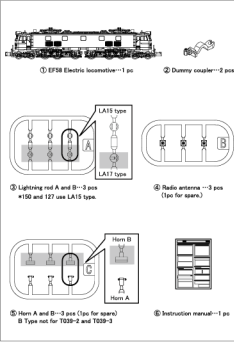

3. How to set pantograph height

Please use tooth pick or similar tool (See Figure 1).

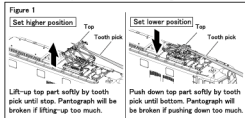

4. How to install the accessory parts

4-1 How to install Lightning rod and horn

Please set Lightning rod and horn in place (See Figure 2).

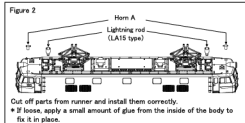

4-2 How to install Radio antenna

(Recommended for advanced modelers)

- The parts process to be done from now on is for advanced users who understand the model.
- When processing, please handle the tools carefully to avoid injury, and work carefully after completely understanding the structure of this product.
- When installing a Radio antenna, it is necessary to drill a hole with a diameter of 1mm.

We have not drilled any holes to install radio antennas to allow you to register your preferred train type.

When installing, please refer to Figure 3.

*The actual 127 does not have a radio antenna.

- ① Remove the chassis while widening the edge of the body, and remove the light unit carefully with tweezers. (Be careful not to damage the headlight parts.)

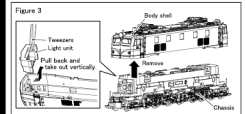

- ② Drill a hole with a diameter of 1mm along the guide hole inside the body. For 150, the radio antenna will be installed inside the car body (near the headlight).

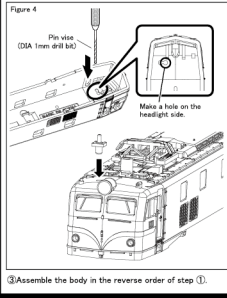

5. How to install and remove the front wheel bogey

You can pull out the leading wheel bogey by referring to Figure 5. Reassemble the main body in the reverse procedure. Be careful of parts coming off.

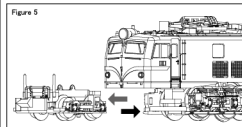

If the part comes off, bend it 90 degrees and push it in from above to return it to its original position, referring to Figure 6. Please pay attention NOT to lost the spring.

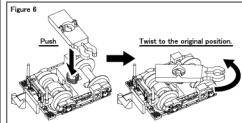

6. How to install Dummy coupler

This product is installed with EF58-specific Arnold couplers; Dummy couplers can be added if desired.
* Due to the mounting structure, couplers (sold separately) not dedicated to this product cannot be used.

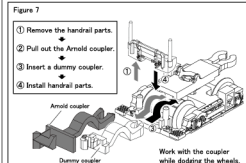

7. Maintenance

- If this product does not work, make sure feeder cable and power are plugged in a place properly, then the positions of main switch and direction selector on controller should be checked. Also please make sure batteries for controller are set in place if using without AD adapter.
- The metal wheels and tracks may be dirty if this product does not run smoothly. Please remove the dirt on the metal wheels and tracks with a clean cloth and rail cleaner.
- Do NOT put excessive power on the wheels when cleaning them up.
- This product is precision model. Please pay attention. To avoid damaging engine, do, drop or put excessive pressure, on it. Handle it with care.

8. Trouble and repair

- Any trouble, accident, or injury caused by misuse, disassembling and modification of this product are not responsibility of Rokuhan. And Rokuhan does NOT accept repair requests of any products which have been disassembling or modified.
- Product specification and appearance are subject to change without prior notice.
- Available only as completed product.
- Contact Rokuhan customer service if you have any questions about this product.