

Thank you for purchasing this Rokuhan product.  
This product is precise. Please read this instruction manual carefully before operation and operate properly.

## 1. Caution

- Use only a Rokuhan controller to operate this product.
- Clean track (Metal rails) before operation.
- Remove dirt and dust on wheels.
- Do not operate continuously over a long period of time.
- Do not suddenly change train direction. Stop train first then change direction.
- In the case of derailment or short circuit, turn off the power of controller, unplug the controller, and then eliminate the cause of problem.
- Disassembling and modification could cause failure of this product.
- Storing this product in direct sunlight or fluorescent light for long time could cause change in color.
- Store and operate this product in dry dust free locations, away from sources of heat.
- To avoid shock or electrocution, do not operate this product in a wet location or operate with wet hands.
- This product includes sharp parts. Handle with care.
- Handle tools with care.
- This product is not recommended for use by children under 8 years old unless supervised by an adult.

## 2. Parts list

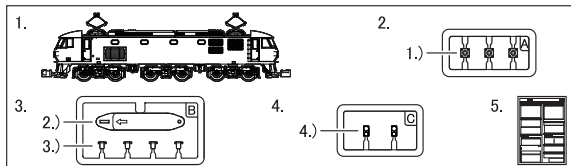

1. EF210 Electric locomotive	1 pc
2. Runner parts A	1 pc
1.) Radio antenna	3 pcs (1 pc. is a spare.)
3. Runner parts B	1 pc
2.) Whistle parts set bar	1 pc
3.) Whistle parts	4 pcs (2 pcs. are spares.)
4. Runner parts C (Included with T018-1, T018-2, T018-3 only)	1 pc
4.) GPS	2 pcs (1 pc. is a spare.)
5. Instruction manual	1 pc

## 3. How to set pantograph height

Please use tinner stick or similar tool. (See Figure 1)

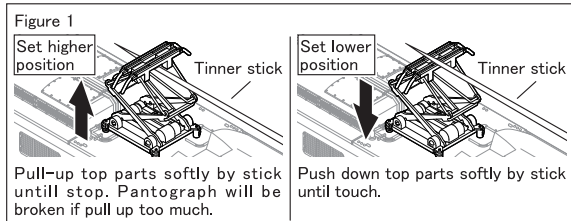

## 4. How to set the accessory parts

Press whistle parts, Radio antenna and GPS softly into the hole on the body. (See Figure 2)

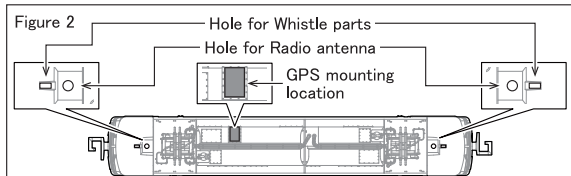

All EF210 series locomotives are not equipped with GPS.  
Thus, there is no hole on the body and consumers will make it by themselves. Please install GPS according to following instruction.

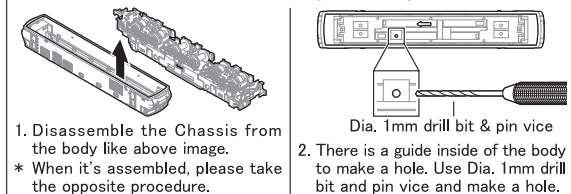

1. Disassemble the Chassis from the body like above image.  
\* When it's assembled, please take the opposite procedure.

2. There is a guide inside of the body to make a hole. Use Dia. 1mm drill bit and pin vice and make a hole.

## 4-1. Set Whistle parts

Take off Whistle parts and Whistle parts set bar from runner, set Whistle parts into bar. Push in Whistle parts softly into the body. (See Figure 3)

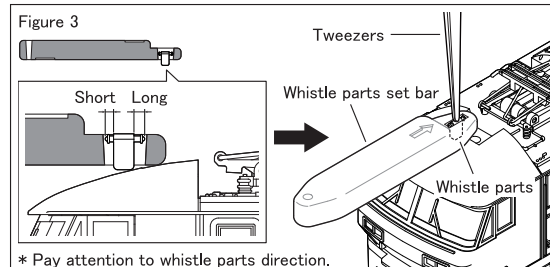

\* Pay attention to whistle parts direction.

## 4-2. Set Radio antenna and GPS

Take Radio antenna and GPS apart from the runner. Press the Radio antenna and GPS softly into the hole on the body. (See Figure 4)  
\* Pay attention to the direction of Radio antenna and GPS.

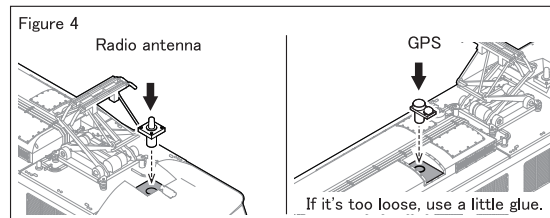

## 5. How to exchange Coupler

Arnold coupler (Short) in default, Can exchange to another ROKUHAN snap in coupler set.

- A019 Knuckle coupler (Short)
- A020 Knuckle coupler (Long)
- A021 European coupler (Short)
- A022 European coupler (Long)
- A025 Arnold coupler (Long)

Pull out original coupler softly from body. Push in another coupler. (See Figure 5)

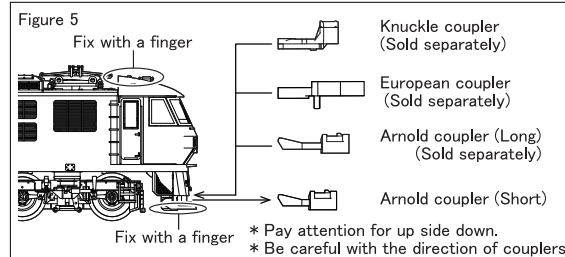

\* Pay attention for up side down.  
\* Be careful with the direction of couplers.

## 6. Maintenance

- If EF210 does not run, check feeder cable and power are plugged in correctly, the positions of main switch and direction switch on controller. Also check batteries are set correctly in controller if batteries are used as power.
- The wheels and track may be dirty if EF210 does not run smoothly. Remove the dirt on the wheels and track with a clean cloth and rail cleaner. \* Do not put excessive power on the wheels when you clean it.
- Precise parts are used to make EF210. Please pay attention not to damage, drop or put excessive pressure. Handle it with care. If it is broken, be careful not to be injured by the broken piece or not to accidentally swallow it.

## 7. Trouble and repair

- The user is responsible for any trouble, accident, or injury caused by misuse, disassembling, or modification of this product. Rokuhan will not repair a product which has been opened, taken apart, or modified.
- Specification and appearance of our products are subject to change without prior notice.
- We sell assembled product only.
- Contact Rokuhan customer service if you have any questions about this product.