

BUMPER SET FOR 113 TYPE (INSTRUCTION MANUAL)

THIS IS THE BUMPER SET TO CONNECT
113 TYPE HEAD CAR EACH OTHER.

CONTENTS

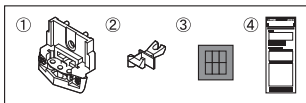

- ① SKIRT PART - 2 PCS
- ② ARNOLD COUPLER - 2 PCS
- ③ LABEL TO PREVENT LIGHTING LEAKAGE - 1 PC
- ④ INSTRUCTION MANUAL - 1 PC

METHOD TO REPLACE THE SKIRT PART

DISASSEMBLE THE BODY FROM CHASSIS
REPLACE THE SKIRT PART (SEE IMAGE 1)

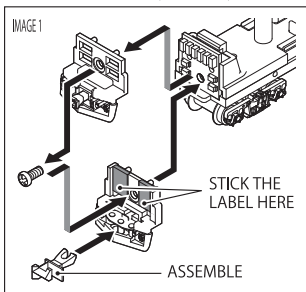

*A SCREW DRIVER + IS NECESSARY TO PROCEED
BASED ON THIS INSTRUCTION.